

2105 MORNINGSTAR LANE, OSHKOSH, WI, 54904

https://www.adashunjones.com

2105
MORNINGSTAR
Lane, OSHKOSH,
WI, 54904



\$789,900

Custom built Cypress luxury home that includes quality and excellence! Stunning 5 bedroom, 3.5 bath ranch style home with many upgrades. Captivating foyer that leads into this gorgeous home with natural lighting. The open floor plan boasts a gas fireplace/oversized windows, granite kitchen island and tops with a walk in pantry The beautiful primary suite consists of...

- 5 beds
- 4 baths
- Residential
- Residential
- Active
- 3077 sq ft



Colleen
Coldwell Banker Real Estate Group

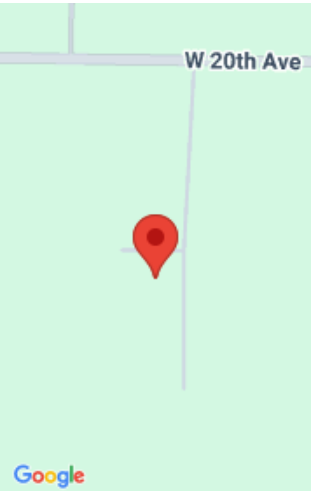

Features

GarageYN: No

FireplaceYN: No

ExteriorFeatures: Patio

Features: At Least 1 Bathtub,Cable Available,Gas,Hi-Speed Internet Availbl,One,Split Bedroom,Vaulted Ceiling,Walk-in Shower

Below Grade Finished Area, sq ft: 848

Inclusions: Refrigerator, Stove, Dishwasher, Microwave, Washer, Dryer.

AttachedGarageYN: No

PoolPrivateYN: No

Lot Features: Corner Lot

Above Grade Finished Area, sq ft: 2229

Tax Amount: 9769

Exclusions: Sellers other personal property not listed above as included.

Amenities

Waterfront available: No

Water Source: Municipal/City

Amenities:

Dishwasher,Disposal,Dryer,Microwave,Range,Refrigerator,Washer

Sewer: Municipal Sewer

Room Sizes

Room type	Dimensions	Level
Bedroom 1	15x14	Main
Bedroom 2	12x11	Main
Bedroom 3	12x11	Main
Bedroom 4	10x10	Main
Bedroom 5	11x11	Lower
Family Room	30x17	Lower
Kitchen	13x17	Main
Living Or Great Room	18x17	Main
Dining Room	11x14	Main
Other Room	6x10	Main
Other Room 2	9x5	Main

Building Details

NewConstructionYN: No

Heating: Forced Air, Central A/C

Exterior material:
Patio,Stone,Stucco,Vinyl

ArchitecturalStyle: Prairie/Craftsman

Basement: Full,Full Sz Windows Min 20x24,Partial
Fin. Contiguous,Radon Mitigation System,Sump
Pump

Parking: Attached,Basement Access,Opener
Included

Agent Details

Agent Full Name: Colleen R Longworth

Agent Email: clongworth@coldwellhomes.com

Open House

• **04/27/25**13:00 to 15:00